

# QUICK START GUIDE

Make sure you follow these instructions for a quick start with the TC500A72V for SurRon LightBee / Segway X260 and Talaria MX4

**Connect the wires as shown below! Use only screws and tools included in the box. The Product must be used in combination with the **stock circuit breaker** at all times! In case of incorrect installation, you will lose the Warranty and cause serious damage to the Product!**

**TC500 Controller is not an original SurRon/Segway/Talaria part so you are using it at your own risk.**

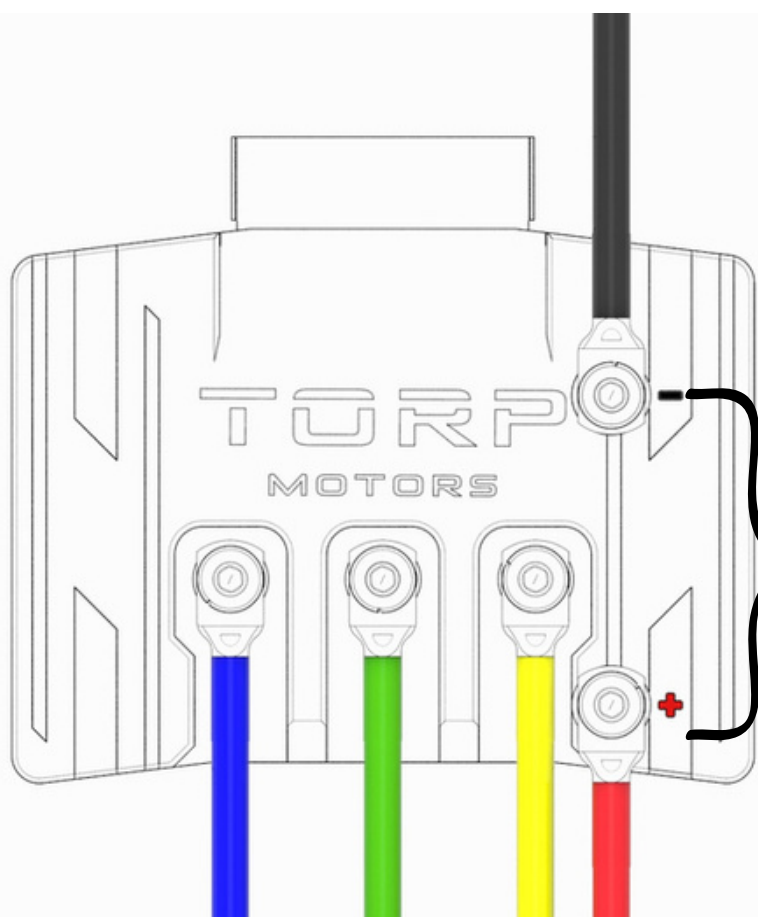

## Power Wires

Make sure to connect:

The **red battery wire** to the positive (+) electrode ●

The **black battery wire** to the negative (-) electrode ●

## Phase Wires\*

Make sure to connect:

The **Blue motor** wire to the the letter B ●

The **Green motor** wire to the the letter G ●

The **Yellow motor** wire to the letter Y ●

For proper installation watch the Installation Video:

SurRon LB



Talaria



M6 screws with Washers

**Max Torque 3.5 Nm Fasten lightly!**

Use only tools included with the controller! Any damage caused by torque higher than 3.5 Nm and tools that are not part of the original package is not covered by warranty!

**\*Not connecting phase wires correctly can cause the bike to go in reverse!**

For additional help contact us at [support@torp.hr](mailto:support@torp.hr)

# ALWAYS USE A CIRCUIT BREAKER (FUSE) WITH TC500!

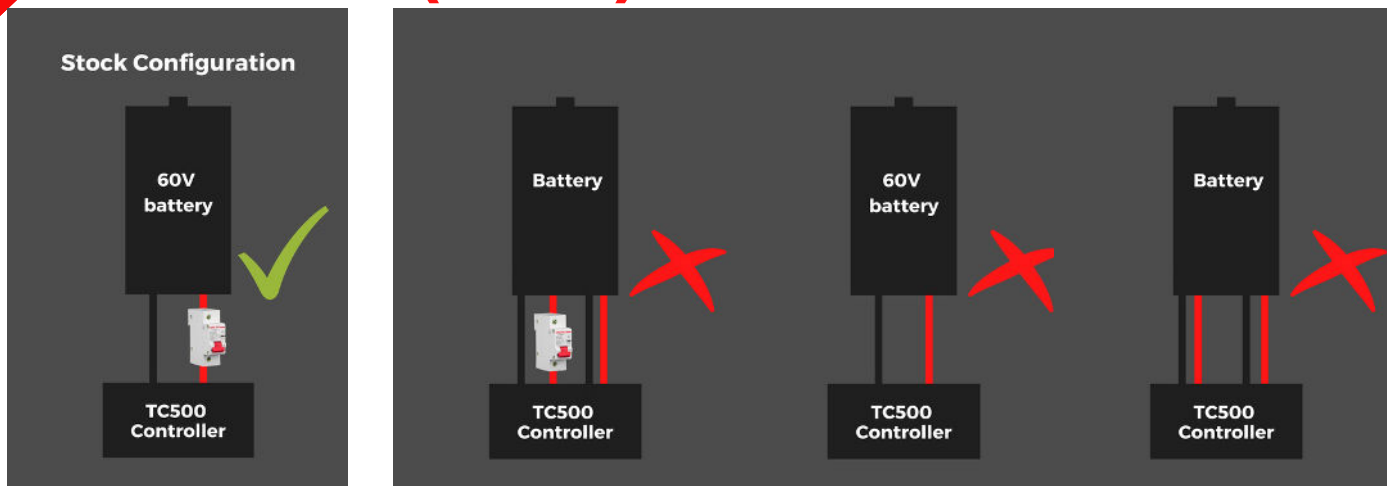

The TC500 controller must always be used with a stock SurRon/Segway/Talaria circuit breaker (fuse)! Not using the circuit breaker with the TC500 controller is dangerous and can cause serious damage!

## CONNECTING THE WIRING.

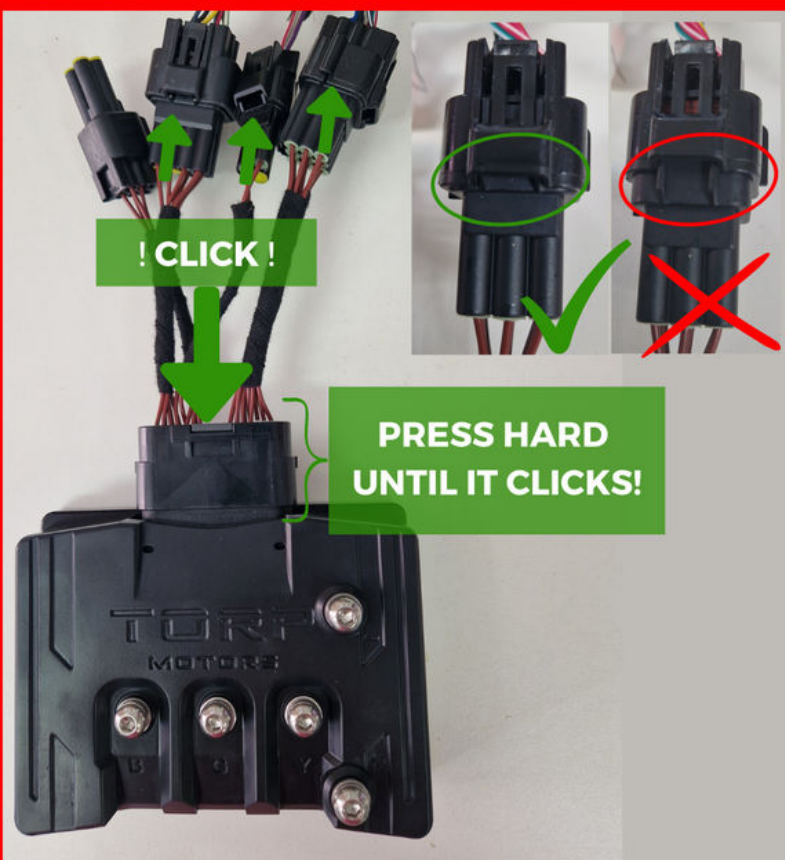

### VERY IMPORTANT!

When pressed together, all connectors **must** make a **clicking sound!**

Especially, make sure that the **main the connector is pressed hard and clicks when pressed!**

When connectors are not properly pressed together, dirt and moisture can enter them, causing the controller irreparable damage!

Improper installation may void your warranty.

Follow the instructions carefully to maintain coverage.

Modifying a stock electric vehicle can make it non-compliant with local road safety regulations. It's crucial to consult experts or authorities before any modifications to ensure road legality.

For additional help contact us at [support@torp.hr](mailto:support@torp.hr)